



L'Entrée

L'Entrée is just a stone's throw away from the Congress Center Basel. It is accessed via a generously dimensioned foyer on the ground floor, from where an escalator leads up to this spacious room on the first floor. The area is ideally suited to banquets, seminars, press conferences and events.

The room holds 600 people, and banquets are possible for up to 370. L'Entrée is linked directly to Halls 1 and 3 at Messe Basel. During trade fairs, organisers frequently use the infrastructure to stage accompanying events.

L'Entrée: Facts and figures

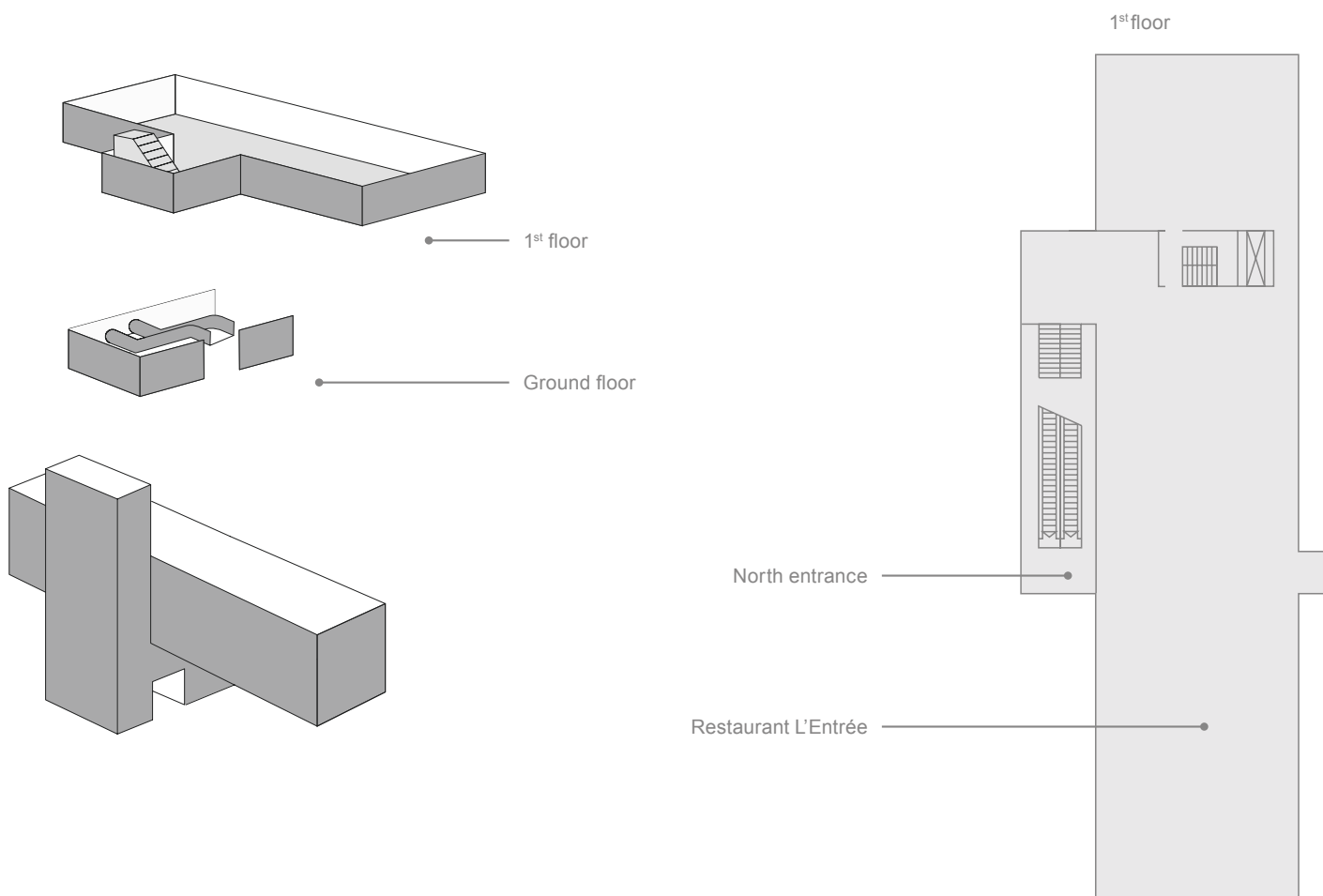

Key figures

Area in m ²	751
Clear height in m	3
Concert seating	594
Seminar seating	312
Banquet seating	363
Cocktails	600
Stage/podium	Mobile installation
Sound system	Permanent installation
Simultaneous interpreting system	Mobile installation
Interpreters' booths	Mobile installation
Discussion system	Mobile installation
Video and data projection	Mobile installation
Film screens	Mobile installation
Lighting system	Mobile installation