



Foyer South and Gallery

From the tram stop, you can reach the inviting Foyer South entrance zone all on the same level, going past the Brasserie Monsieur Verseau. Behind the extensive glass frontage, which forms part of the spatial transparency of the hall complex designed by Herzog & de Meuron, the Foyer South offers a gross surface area of some 1900 m², including the gallery.

With its unique location in the City Lounge, the Foyer South is particularly suitable for receptions, small exhibitions, cocktails and as a meeting space for up to

1000 people. The gallery with its unique view into the City Lounge holds up to 700 people.

The Foyer South can be used in combination with the MCH Lounge or with the pillar-free Event Hall behind it. The Foyer South is linked directly to the Congress Center Basel via the walkway.

A unique inscription system with a 112-metre-long LED strip can be customised for specific events, showing guests the way to the event from a long way off.

Foyer South: Facts and figures

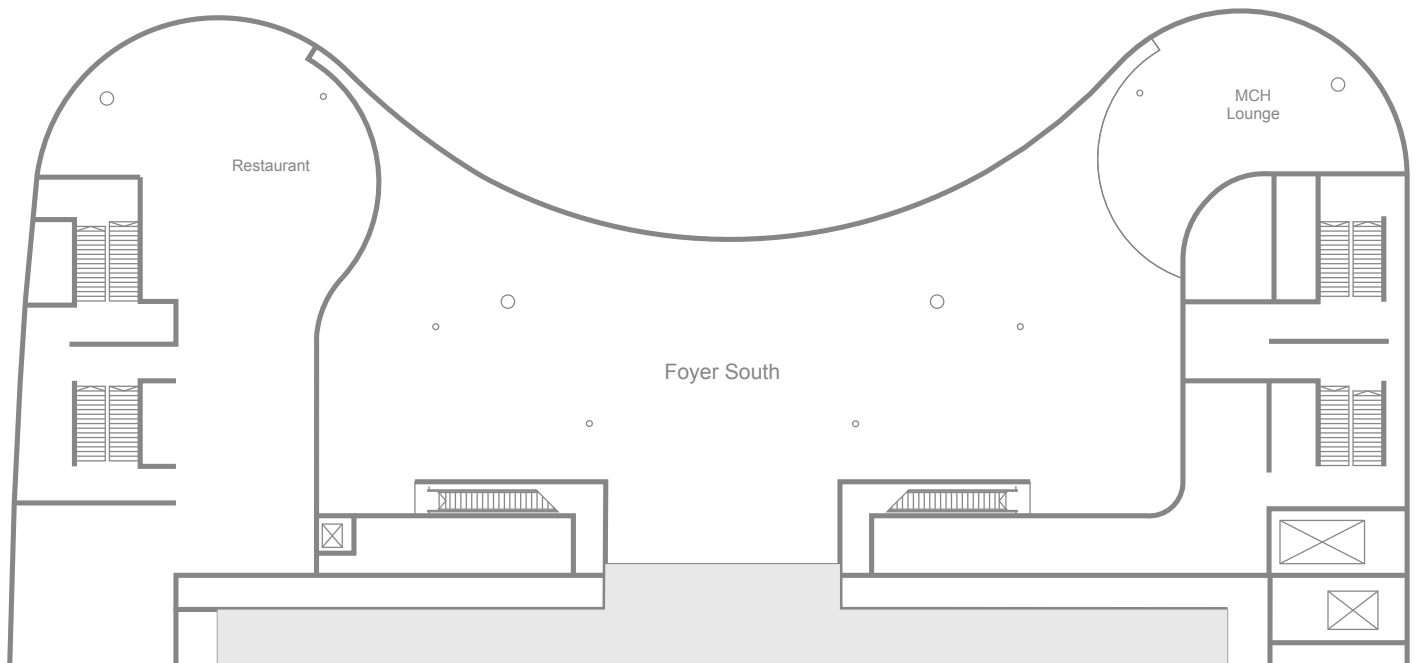

Key figures	
Area in m ²	1913 incl. gallery
Clear height in m	8.6 ground floor 2.8 gallery
Concert seating	– (not recommended)
Seminar seating	– (not recommended)
Banquet seating	300
Cocktails	1000 GF 700 gallery
Stage/podium	Mobile installation
Sound system	Mobile installation
Simultaneous interpreting system	–
Interpreters' booths	–
Discussion system	–
Video and data projection	Mobile installation
Film screens	Mobile installation
Lighting system	Mobile installation